



# TL-300

Deployable portable lighting in one bespoke robust package.

Portable  
Tripod  
Light



# HIGHER, BRIGHTER, MORE STABLE

Expanding or retracting requires just two steps and can be completed in 10 seconds.



1 Release the legs



2 Release and rise the extension pole

Secure the lamp at any height with the buckle.



One-click release or lock of the legs.



Ground pegs are available to secure the light tower, providing wind and vibration resistance. (Optional)

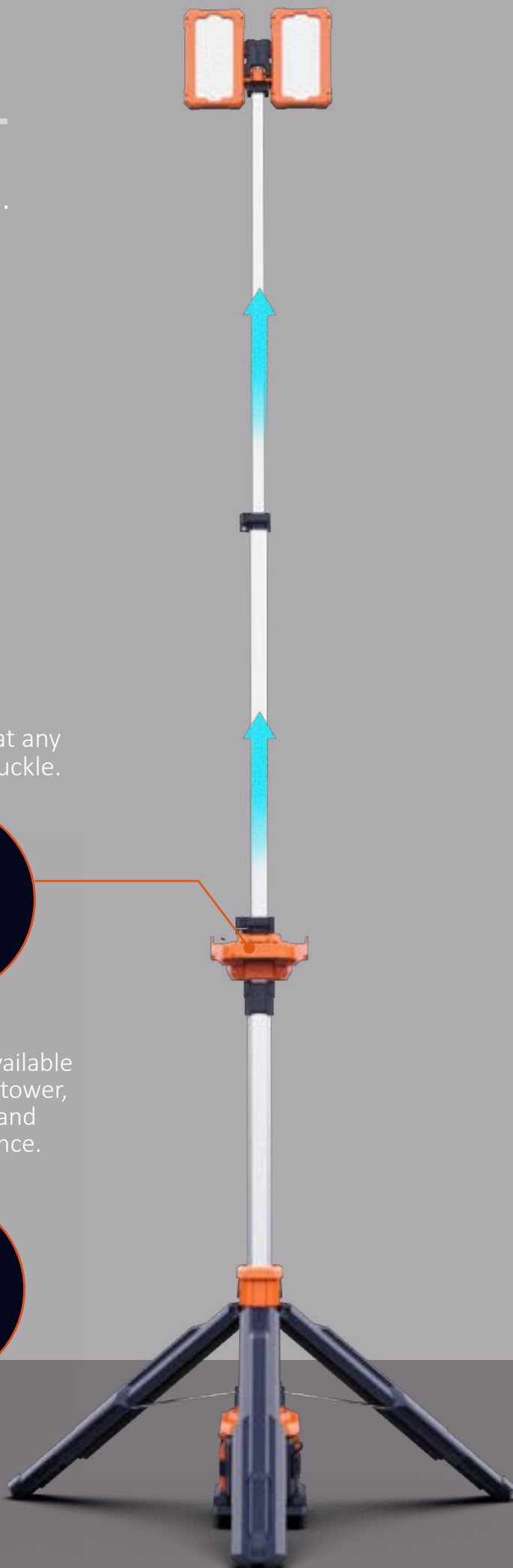
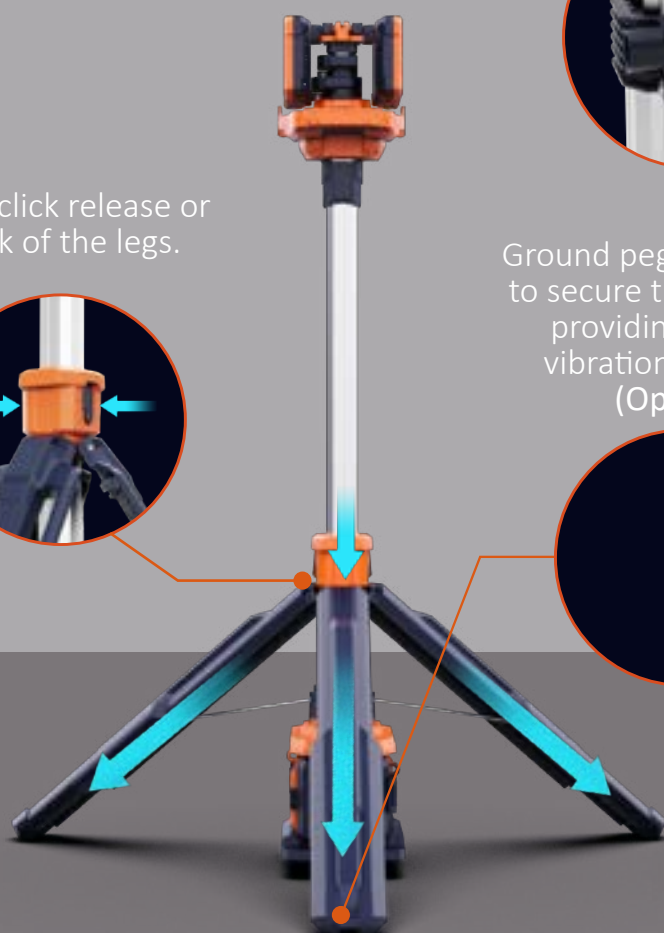
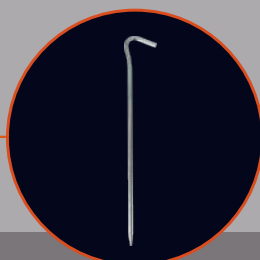

# HUMANIZED DESIGN HIDDEN IN THE DETAILS

---



## USB Output

Dual rainproof USB outputs for charging two devices at once, rain or shine.



## Phone Stand

Continue working while charging, the hook here can serve as a phone stand.



## Stepless Dimming

Plug the driver into the rainproof port to unlock maximum brightness and stepless dimming.

# LOWER CENTER OF GRAVITY, GREATER STABILITY.

---

Ultra-low center of gravity combined with extended legs effortlessly handles strong winds and slopes.





# Ultra-long working hours

Standard Mode Up To **13+** Hours  
(D24-100 x2)

2 types of battery packs with different capacities have same contact slot.



D24-54 x 2

Typical working hours 36+ hours on Eco mode.



D24-100 x 2

Doubled typical working hours to 71+ hours.

Battery compartment fits  
two replaceable battery packs.



# High light efficiency illuminating a wider space

Equipped with high-brightness LED light source and high-quality optical lens system

AC Powered

Up To **14,000**  
LM

Battery-powered

Up To **8,000**  
LM

**Stepless Dimmable** (AC Powered)

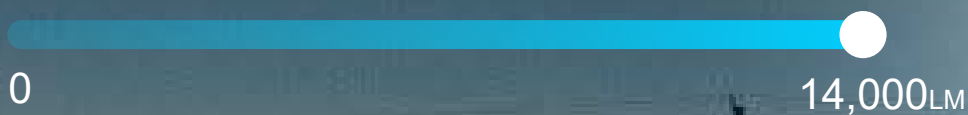

**4 Levels of Brightness** (Battery Powered)

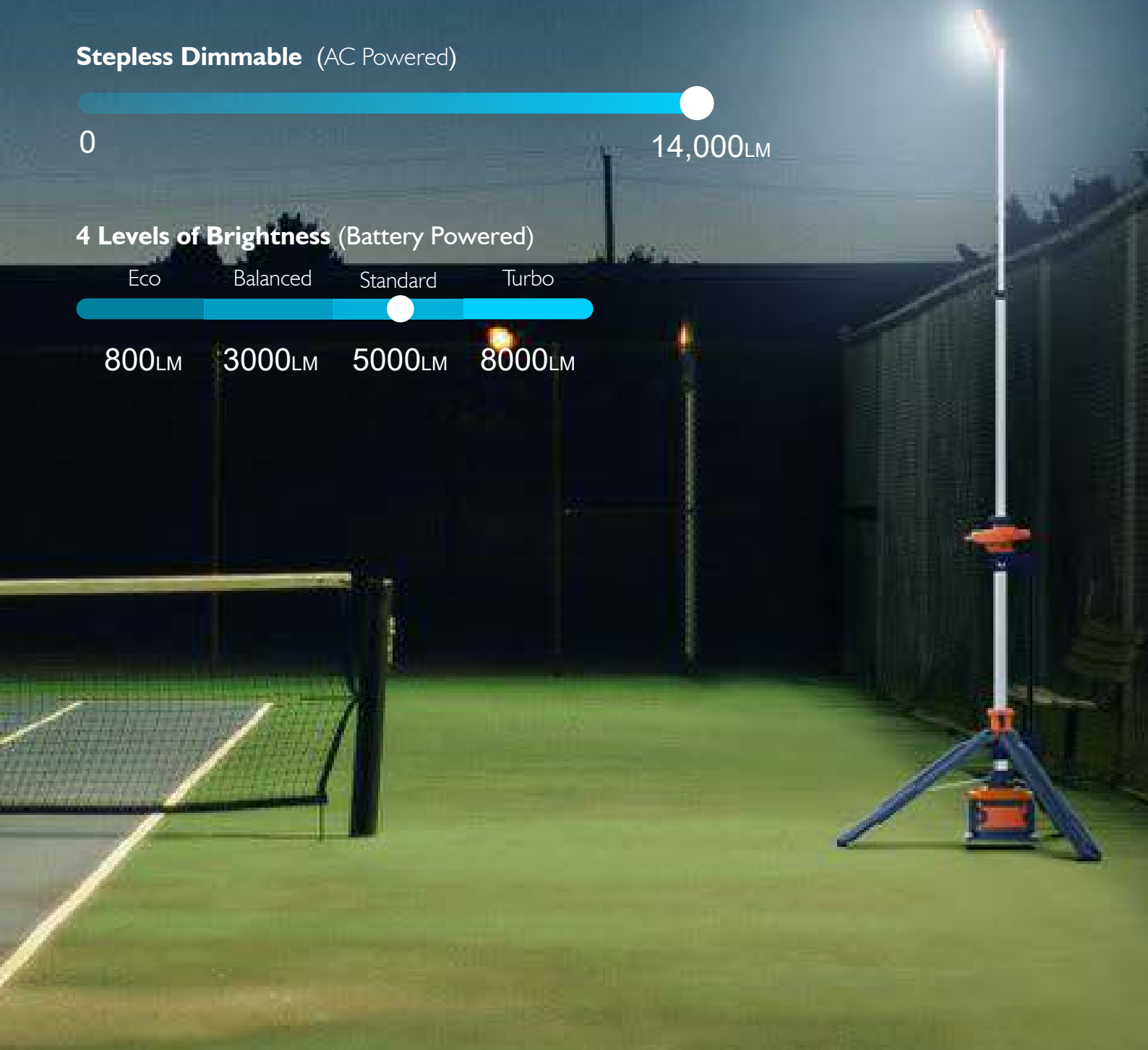
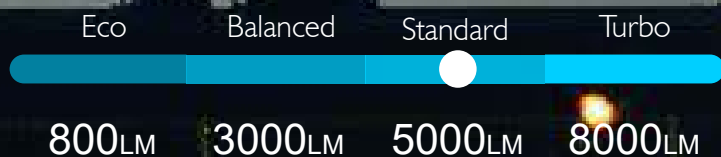



Construction



Emergency



Sport

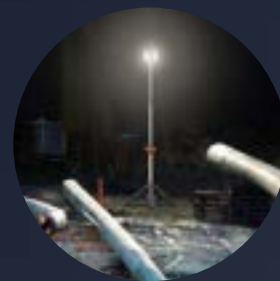

Maintenance



Infrastructure



Outdoor activities

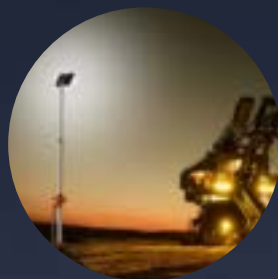

Mining



Railway

## Designed for single-person operation

Easy to grip and move,  
weight 8.2 kg excluding battery pack.

1.25m

3.1m



# Specifications

## TL-300

Height	1.25m-3.1m
Weight	8.2KG (Fitting only)
Power Supply	D24 series battery pack / AC 100-277V
Lumens	0-14000Lm
Run Times	>13h10mins (Standard mode, D24-100 x 2)
IP Grade	IP66
Output(USB)	5V 2A
Operating Temp	-10℃ -50℃



## Size (mm)

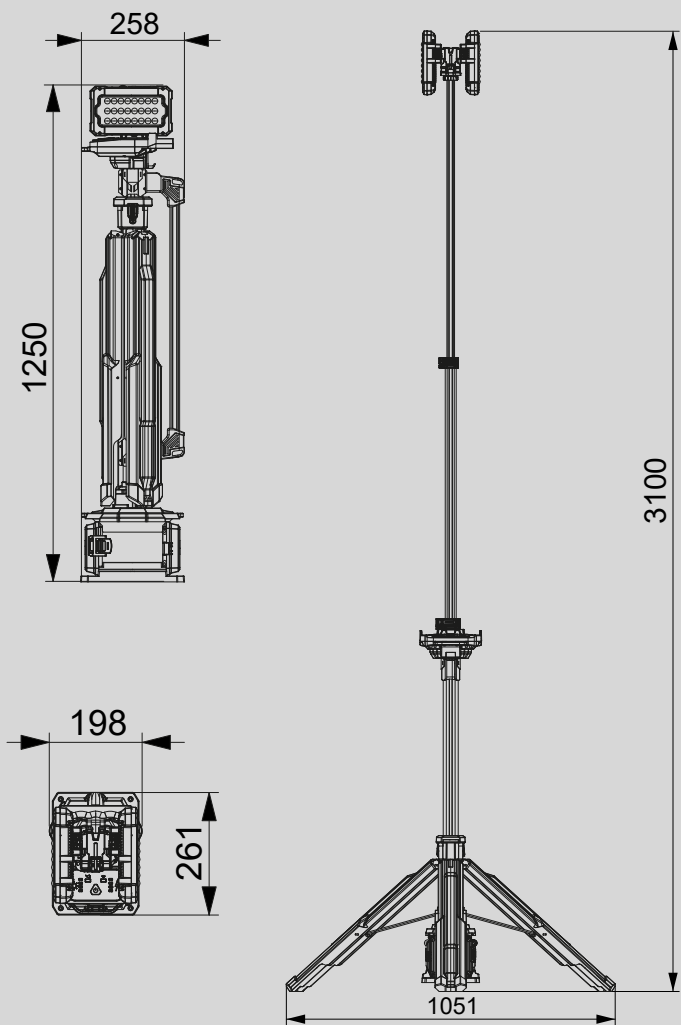

## Package

Model	TL-300
Size of Carton	1350x280x390mm
Gross Weight of Carton	11.5KG
PCS/Carton	1

